

Features

- Color options: Single color.
- Design: Superior design with exquisite craftsmanship ensure stable and reliable performance.
- Flexibility: Top bending, min. bend diameter 120mm[4.72inch].
- IP grade: Molding pressed IP68 protection. Glue process end caps IP67 protection.
- Warranty: 5 years indoor, 3 years outdoor.
- Customization: multiple spec options, can be customized upon requirements.

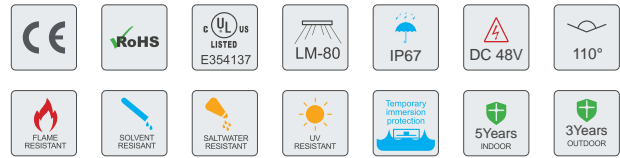

Photo-electric Parameters

Model No.	CRI	Voltage	Color	Lm/m	Lm/W	Measured Power (W/m)
VNL-F16F-48-26K	>80	48V DC	2600K	520	58	9.6±10%
VNL-F16F-48-30K			3000K	550	60	
VNL-F16F-48-42K			4200K	570	63	
VNL-F16F-48-50K			5000K	580	64	
VNL-F16F-48-60K			6000K	560	62	
NDF1617-48V-single color	>90	48V DC	2200K	500	56	9.6±10%
			2600K	520	58	
			2800K	540	59	
			4000K	570	63	
			4800K	590	66	
			5800K	560	62	
VNL-F16F-48-R	48V DC	Red	190	21	9.6±10%	
VNL-F16F-48-G		Green	540	61		
VNL-F16F-48-B		Blue	120	13		
VNL-F16F-48-Y		Yellow	150	17		
VNL-F16F-48-O		Orange	230	26		

Other Parameters

Model No.	LED QTY (pcs/m)	Product Size L*W*H (mm)	Min. Cuttable Length (mm)	Working Temperature	Storage Temperature
VNL-F16F-48	120	35000*16*17	100	-20~+60℃	-20~+70℃

Profile Drawings

Glue Process (IP67)

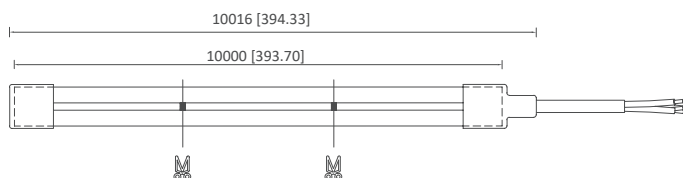

Molding pressed (IP68)

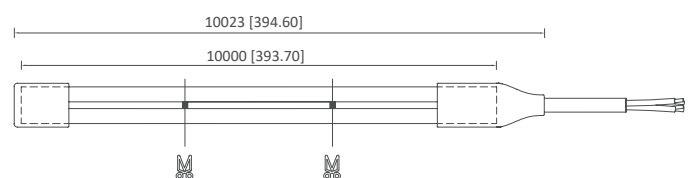

Sectional view

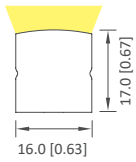

Bending Diameter

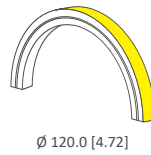

Top Bending

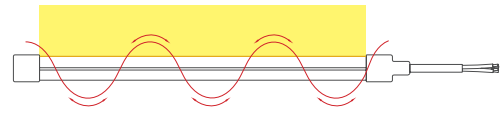

Front cap

Glue Process (IP67)

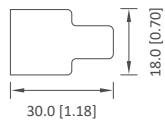

Molding pressed (IP68)

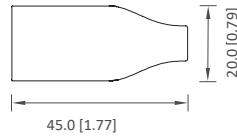

Closing End-cap

Glue Process (IP67)

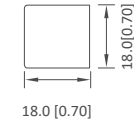

Molding pressed (IP68)

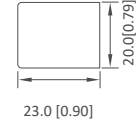

Remarks: "L" is the standard size of the light strip, can be customized according to the multiple of the minimum cutting unit length.

Luminous Intensity Distribution Diagram

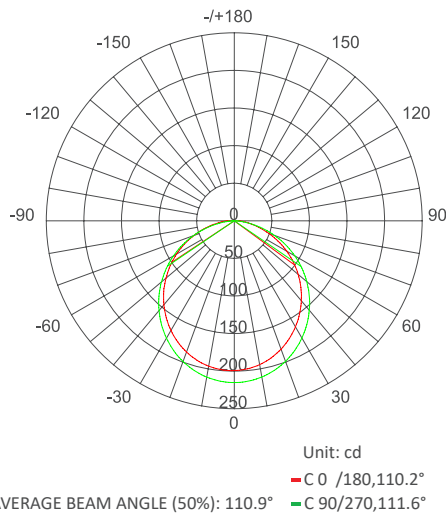

Note: the above two figures are tested with the sample VNL-F16F-48.

Average Illumination

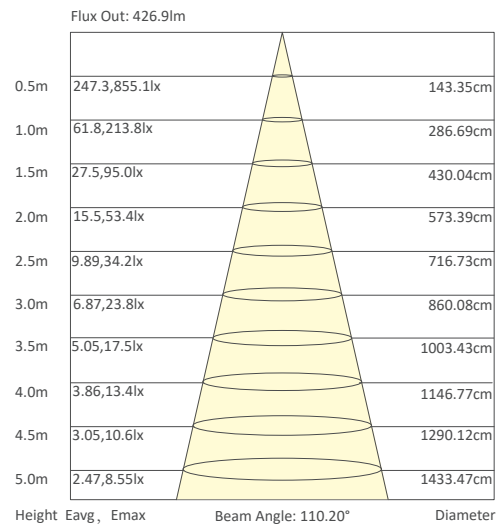

Product accessories

Free

	Front cap VNL-F16F-48-PCS	Quantity (m)/pcs: (5/10) 2/4 Dimensions (L*W*H)mm: 30.0*18.0*18.0		Closing End-cap VNL-F16F-48-ECS	Quantity (m)/pcs: (5/10) 2/4 Dimensions (L*W*H)mm: 18.0*19.0*18.0
--	------------------------------	--	--	------------------------------------	--

Optional

	Front cap (Molding pressed) VNL-F16F-48-PCIM	Quantity (m)/pcs: (5/10) Dimensions (L*W*H)mm: 45.0*19.2*20.2		Closing End-cap (Molding pressed) VNL-F16F-48-ECIM	Quantity (m)/pcs: (5/10) Dimensions (L*W*H)mm: 23.0*19.2*20.2
	Front cap(Side) VNL-F16F-48-PCB	Quantity (m)/pcs: (5/10) Dimensions (L*W*H)mm: 25.0*30.0*19.0		3.5cm Aluminum track VNL-F16F-48-AP35	Quantity (m)/pcs: (5/10) Dimensions (L*W*H)mm: 35.0*21.2*19.0
	Aluminum Channel VNL-F16F-48-AP1000	Quantity (m)/pcs: (5/10) Dimensions (L*W*H)mm: 1000*19.3*18.7		S-type Track VNL-F16F-48-SP500	Quantity (m)/pcs: (5/10) Dimensions (L*W*H)mm: 500*17.2*17.8
	Screws	Quantity (m)/pcs: (5/10): 10/20 Dimensions: 10mm		Silicone Glue VNL-SG45	Quantity (m)/pcs: (5/10) 1 300g/pc